



# Government Gazette Staatskoerant

REPUBLIC OF SOUTH AFRICA  
REPUBLIEK VAN SUID AFRIKA

Vol. 707

21

May  
Mei

2024

No. 50681



N.B. The Government Printing Works will not be held responsible for the quality of "Hard Copies" or "Electronic Files" submitted for publication purposes

ISSN 1682-5845



**AIDS HELPLINE: 0800-0123-22 Prevention is the cure**

**IMPORTANT NOTICE:**

**THE GOVERNMENT PRINTING WORKS WILL NOT BE HELD RESPONSIBLE FOR ANY ERRORS THAT MIGHT OCCUR DUE TO THE SUBMISSION OF INCOMPLETE / INCORRECT / ILLEGIBLE COPY.**

**No FUTURE QUERIES WILL BE HANDLED IN CONNECTION WITH THE ABOVE.**

**Contents**

| <i>No.</i> |  | <i>Gazette<br/>No.</i> | <i>Page<br/>No.</i> |
|------------|--|------------------------|---------------------|
|            | <b>GOVERNMENT NOTICES • GOEWERMENTSKENNISGEWINGS</b>   |                        |                     |
|            | <b>Trade, Industry and Competition, Department of / Handel, Nywerheid en Kompetisie, Departement van</b> |                        |                     |
| 4850       | Special Economic Zones Act (16/2014): Designation of the Namakwa Special Economic Zone .....             | 50681                  | 3                   |

---

**GOVERNMENT NOTICES • GOEWERMENTSKENNISGEWINGS**

---

**DEPARTMENT OF TRADE, INDUSTRY AND COMPETITION****NO. 4850****21 May 2024****DESIGNATION OF THE NAMAKWA SPECIAL ECONOMIC ZONE**

I, Ebrahim Patel, Minister of Trade, Industry and Competition, hereby designate the Namakwa Special Economic Zone (SEZ), in terms of the Special Economic Zones Act No. 16 of 2014. The SEZ's total land area is 1270.06 ha and is located in Namakwa, Northern Cape, bordered on the north by the N14 road, which links to the town of Pofadder to the east and the town of Aggeneys to the west. The Namakwa SEZ land area will comprise of the following three (3) land parcels;

1. Remainder of the Farm Aroams, No. 57 with a total land area of 889.02825 ha, bordered on the north and west by the N14, in the east by Portion 4 of Farm Gams No 60 and the south by Portion 1 of Farm Bloemhoek, No.61;
2. Portion 1 of the Farm Gams, No. 60 with a total land area of 11.82596 ha, bordered on the north and west by Remainder of the Farm Aroams, No. 57, on the east by Portion 4 of the farm Gams No.60 and on the south by Portion 1 of Farm Bloemhoek No 61;
3. Portion 1 of Farm Bloemhoek, No.61 with a total land area of 369.21363 ha, bordered on the north by Remainder of the Farm Aroams, No. 57, in the west by the N14, in the south by remainder of Farm Bloemhoek, No 61 and in the east by Portion 1 of Farm Gams, No 60.

A table listing the erf numbers and maps indicating the boundaries of the SEZ are attached as Annexure A.

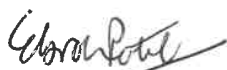
**Ebrahim Patel****Minister: Trade, Industry and Competition**20 / 05 / 2024

**ANNEXURE A**

Table 1: Erf numbers

| <b>Zoning and land use</b>             | <b>Total Area(ha)</b> |
|--|-----------------------|
| E.a.1 Agricultural Industry            | 154.6369523           |
| E.e.1 Extractive Industry              | 90.390324             |
| E.c.2 Industry                         | 78.01267846           |
| E.c.1 Light Industry                   | 120.9783164           |
| D.g.2 Municipal Uses                   | 10.97918934           |
| E.d.1 Noxious Industry                 | 101.9289414           |
| B.c.3 Parks and Open Spaces            | 261.1827021           |
| F.g.1 Power Lines                      | 79.81360056           |
| A.a.5 Protected Environments           | 237.8591875           |
| F.d.1 Public Streets                   | 66.21818518           |
| F.f.1 Railway Facilities               | 58.71691794           |
| F.l.1 Sewerage Plants and Refuse Areas | 9.3508643             |
|  | <b>1270.06786</b>     |

Table 2: MAP of The Proposed Namakwa Special Economic Zones land parcels

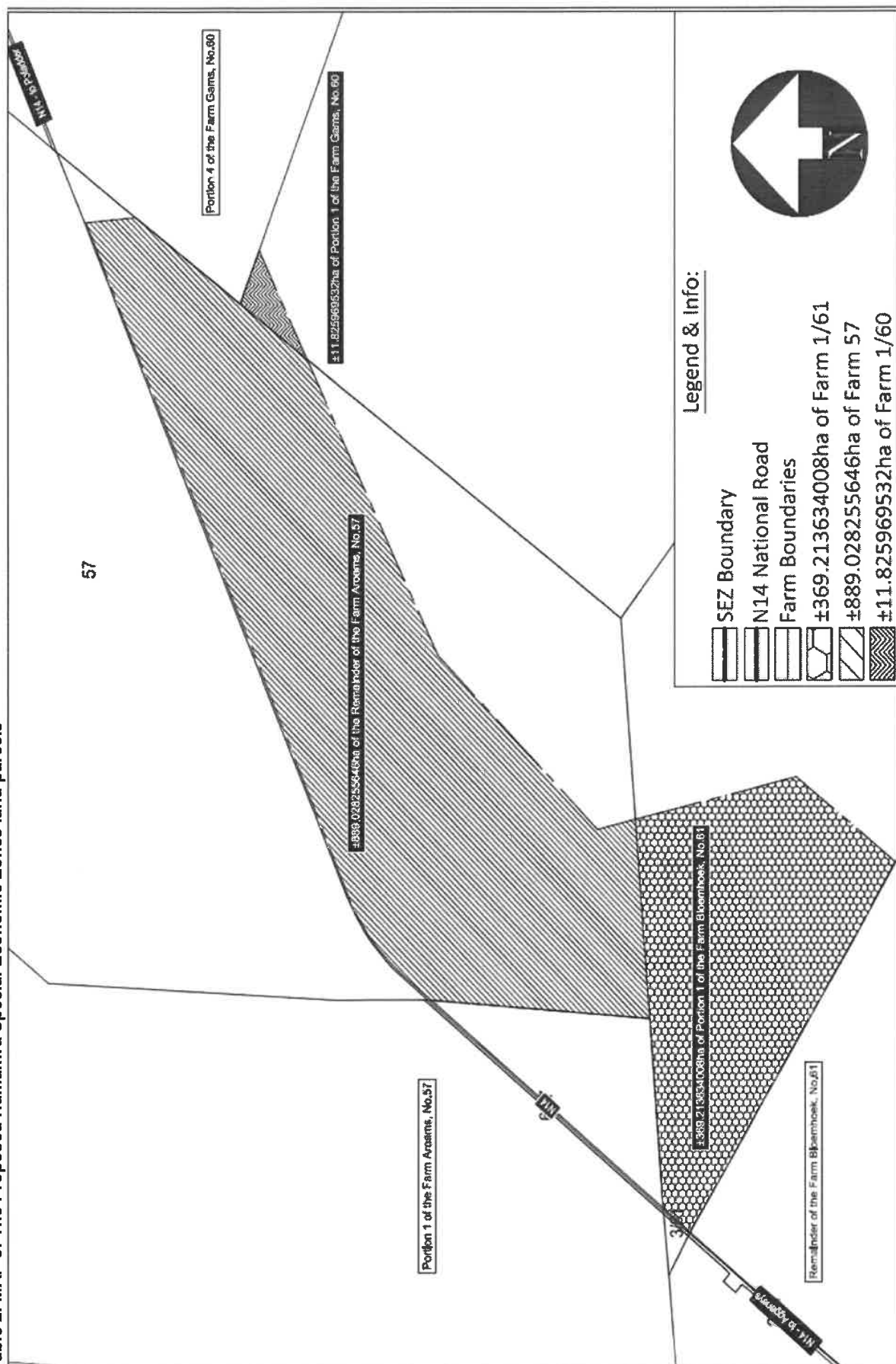





Printed by and obtainable from the Government Printer, Bosman Street, Private Bag X85, Pretoria, 0001  
Contact Centre Tel: 012-748 6200. eMail: [info.egazette@gpw.gov.za](mailto:info.egazette@gpw.gov.za)  
Publications: Tel: (012) 748 6053, 748 6061, 748 6065